

**SLOPE DETAIL**  
NO SCALE

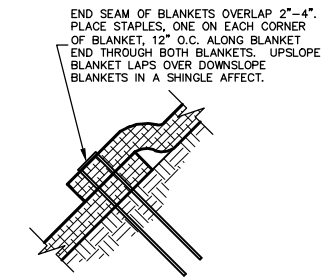

**END ROLL OVERLAP**  
NO SCALE

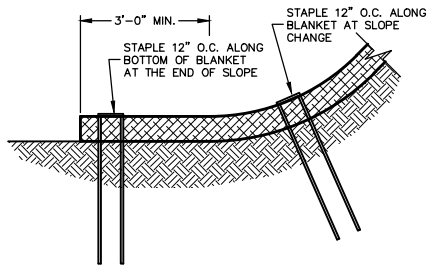

**BOTTOM OF SLOPE TERMINATION IF INSTALLED 3' BEYOND THE TOE OF SLOPE**  
NO SCALE

### Curlex® CL Staple Pattern Guide

For 8 ft wide Curlex CL Erosion Control Blankets  
Adjust horizontal staple spacing for 4ft and 16 ft wide Curlex Erosion Control Blankets

Application	Slope		
	≤ 4H:1V	≤ 3H:1V	≤ 1.5H:1V
Staple Pattern	A	B	C

● = Staple Placement

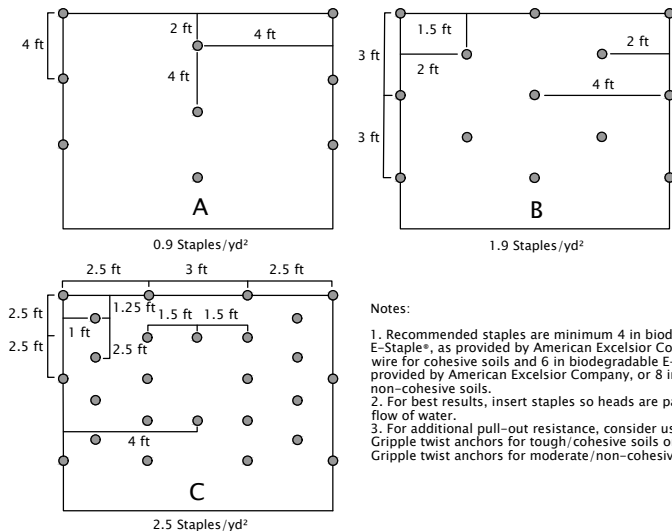

#### Notes:

1. Recommended staples are minimum 4 in biodegradable E-Staple®, as provided by American Excelsior Company, or 6 in wire for cohesive soils and 6 in biodegradable E-staple®, as provided by American Excelsior Company, or 8 in wire for non-cohesive soils.
2. For best results, insert staples so heads are parallel to the flow of water.
3. For additional pull-out resistance, consider using TL-TA2 Gripple twist anchors for tough/cohesive soils or TL-TA1 Gripple twist anchors for moderate/non-cohesive soils.

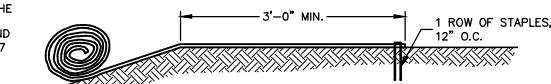

**OVER SLOPE CREST METHOD**  
NO SCALE

DO NOT NEED TO TRENCH BLANKET IN IF IT CAN BE EXTENDED A MINIMUM OF 3'-0" OVER THE CREST OF THE SLOPE.

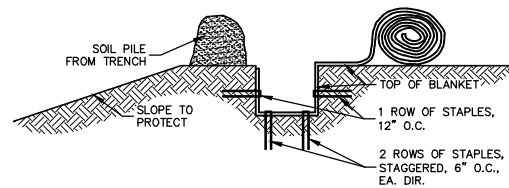

**STEP 1**

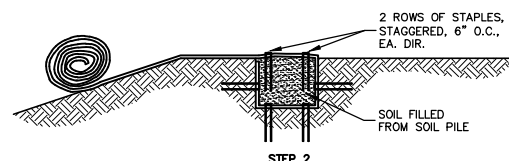

**STEP 2**

**SLOPE TRENCHING METHOD "A"**  
NO SCALE

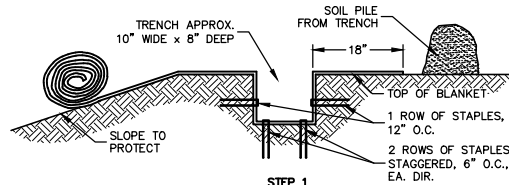

**STEP 1**

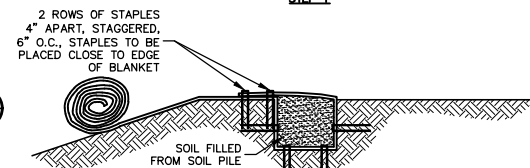

**STEP 2**

**SLOPE TRENCHING METHOD "B"**  
NO SCALE

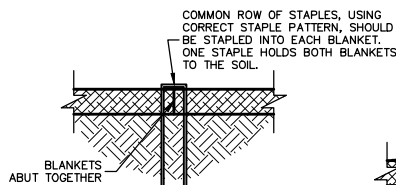

**SIDE SEAM ABUT STAPLE DETAIL**  
NO SCALE

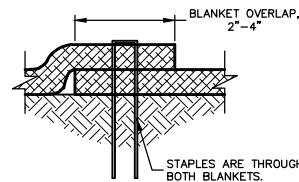

**SIDE SEAM OVERLAP STAPLE DETAIL**  
NO SCALE

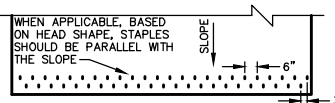

**BOTTOM OF SLOPE TERMINATION IF INSTALLATION 3' BEYOND TOE OF SLOPE IS NOT POSSIBLE**  
NO SCALE

**American Excelsior Company®**  
Earth Science Division

**AMERICAN EXCELSIOR COMPANY**  
ARLINGTON, TEXAS

SHEET DESCRIPTION  
**CURLEX® CL SLOPE APPLICATION DETAIL**

DATE 11/22/23  
SCALE  
NONE

DRAWN BY  
PROJECT NO.  
SHEET NO.  
27